

User Manual

Inhaltsverzeichnis

General information	5
Scope of supply/Parts	5
Technical specifications	5
Explanation of symbols	5
Safety	6
Intended use	6
Safety information.....	7
Safety instructions regarding rechargeable batteries.....	8
Safety instructions for the product.....	8
Start-up.....	9
Legend.....	9
Charging the battery	10
Checking battery charge level	10
Charging battery with USB charging cable	10
Charging the battery with the car charging adapter	11
Use	11
Using the adapters	11
Switching the product on/off	11
Measuring tyre pressure	12
Set pressure	12
Pumping process	12
Auxiliary light on/off	13
Troubleshooting	13
Cleaning and care instructions.....	13
Disposal.....	14



RECHARGEABLE COMPRESSOR



ALDI guarantees that **our exclusive brand** products are developed to our stringent quality specifications. If you are not entirely satisfied with this product, please return it to the nearest ALDI store within 60 days from the date of purchase, for a full refund or replacement, or take advantage of our after sales support by calling the supplier's Customer Service Hotline.

AU

Made in China

BIKEMATE® is a registered trademark of ALDI Stores

DISTRIBUTED BY:

ALDI STORES

1 SARGENTS ROAD

MINCHINBURY NSW 2770

www.aldi.com.au

AFTER SALES SUPPORT

811322



AU 1800 269 981



support@wunsche.com.au

MODEL:
26600

04/2022

1
YEAR
WARRANTY

Ident.-Nr.: P03003007Z_AUFLADBARER-KOMPRESSOR_26600_220621

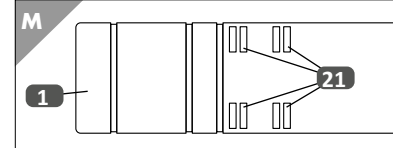
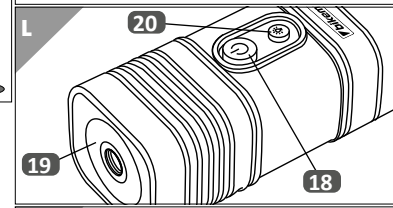
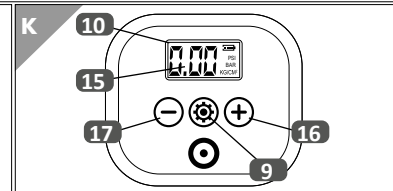
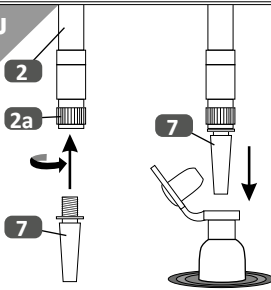
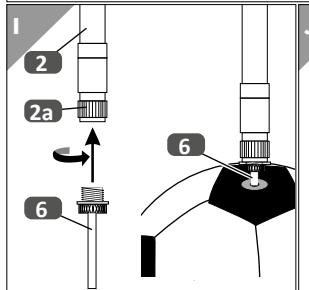
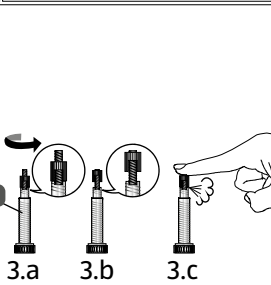
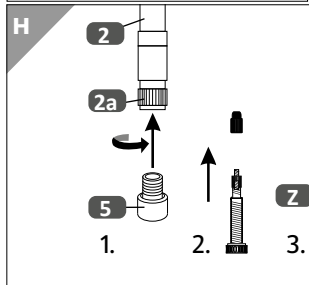
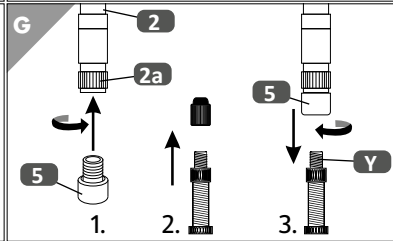
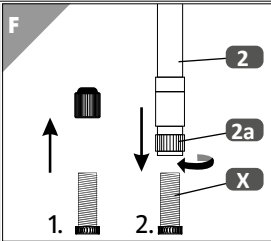
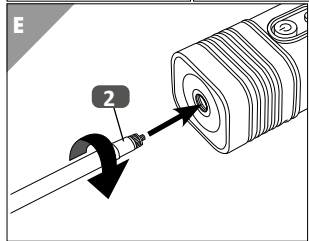
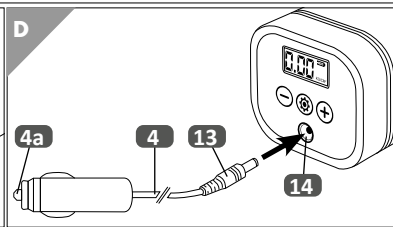
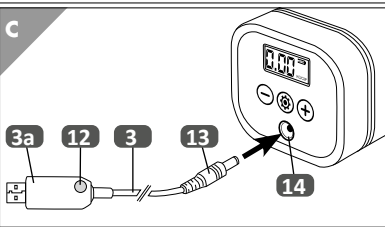
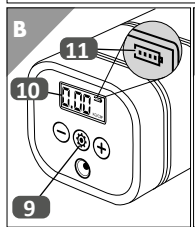
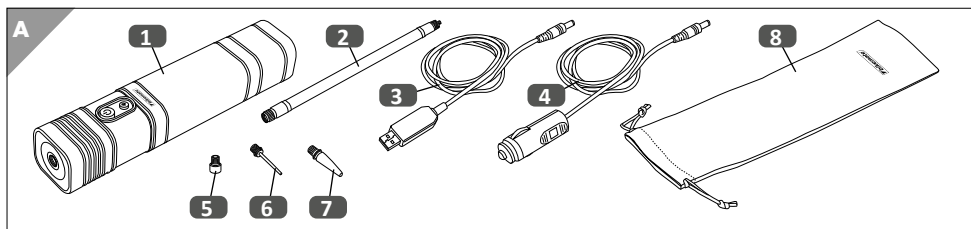

The valves **x**, **y** and **z** are not included in the scope of delivery.

GENERAL INFORMATION



Read and safely store the operating instructions

These operating instructions belong to this Rechargeable Compressor **1** hereinafter referred to as the product. The operating instructions contain important information on how to use the product.

Read the operating instructions, especially the safety instructions, carefully before using the product. Non-compliance with these operating instructions can lead to serious injury or damage to the product. The operating instructions are based on the standards and regulations applicable in the European Union. Also observe country-specific guidelines and laws abroad.

Store the operating instructions for further use. If you pass on the product to third parties, please ensure that you include these operating instructions.

SCOPE OF SUPPLY/PARTS

(Fig. A)

- 1 x Rechargeable compressor **1**
- 1 x Compressed air hose with threaded connection **2**, suitable for Schrader valves
- 1 x USB charging cable **3**
- 1 x Car charging adapter **4**, 12 V
- 1 x Dunlop/Presta valve adapter **5**
- 1 x Metal adapter for balls **6**
- 1 x Plastic adapter for inflatable articles **7**
- 1 x Storage bag **8**
- 1 x Warranty Certificate, without Fig.
- 1 x Operating instructions, without Fig.

TECHNICAL SPECIFICATIONS

Item number: 811322

Batch: P030030072

Model number: 26600

Battery: Lithium-ion

- Capacity: 2,000mAh

- Operating voltage: 12 V

- Power: 22.2 Wh

ta: 50 °C

Input voltage:

- charging connection cigarette lighter socket: 12 V / 8 A

- charging connection USB cable: 5 V / 1 A

Power consumption: max. 10 A

Maximum pressure: 8.25 bar / 120 PSI

Rating Power: 96 W

Continuous operation: max. 5 min*

Air flow rate: 10 l / min

Charging time: up to 12 hours

Weight: 786 g

Date of production: 12/2021

Guarantee: 1 Years



WARNING!

***CONTINUOUS OPERATION: Do not operate the installed compressor continuously for more than 5 minutes. Afterwards, leave it to rest for 15 minutes.**

EXPLANATION OF SYMBOLS

The following symbols and signal words are used in these operating instructions, on the product or on the packaging.



WARNING!







This signal symbol/word indicates a hazard with a high level of risk which, if not avoided, may result in death or serious injury.





⚠ CAUTION!







This signal symbol/word indicates a hazard with a low level of risk which, if not avoided, may result in minor or moderate injury.

NOTE!

This signal word warns of possible property damage or provides you with useful additional information regarding the use.

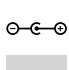
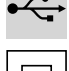
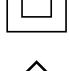
-  This symbol indicates how to use the operating instructions.
-  This symbol indicates interior use only.
-  This symbol indicates usage.
-  This symbol indicates potential danger to children.
-  This symbol indicates the age rating of the product.
-  This symbol indicates potential problems with pressure displays.
-  These symbols indicate ON/OFF switches.

-  This symbol indicates potential danger in relation to electric shocks.
-  This symbol indicates potential danger in relation to overheating.
-  This symbol indicates potential danger in relation to explosions.
-  This symbol indicates potential danger from handling batteries / rechargeable batteries.

-  This symbol indicates that hearing protection must be worn.
-  This symbol indicates the use of the LED.
-  This symbol indicates direct current.
-  This symbol indicates the polarity.
-  This symbol indicates a USB port.
-  This symbol indicates protection class II (Double insulation).
-  This symbol indicates protection class III. SELV: safe extra-low voltage
-  These symbols inform you about the disposal of the packaging and product.
-  The RCM (Regulatory Compliance Mark) indicates a product complies with all applicable Australian regulatory requirements.

SAFETY

Intended use

 This product is not suitable for household room lighting.

This product is suitable for inflating all common bicycle tyres, car tyres, small volume inflating articles, balls, etc. The product is not designed for continuous operation to generate pressure for more than 5 minutes at a time. It was developed to generate air pressure, not volume. The product is not suitable for inflating large-volume articles, such as air mattresses or inflatable boats, as these can heat up quickly without counter-pres-

sure. The product is designed to build up a given air pressure, not to generate large amounts of air. Danger of overheating!

⚠ WARNING!

Risk of injury!

 **The product may not be used near liquids or in damp spaces. There is a risk of injury from electric shock!**

The product is not intended for commercial use. Different use or a modification to the product are not deemed as intended use and may lead to risks, such as injuries and damage. The distributor assumes no liability for damage that results from improper use.

SAFETY INFORMATION

⚠ WARNING!

Risk of strangulation and suffocation!

 **If children play with the product or the packaging, they could become caught in it and suffocate!**

- Do not let children play with the product or the packaging.
- Supervise children who are close to the product.
- Keep the product and the packaging out of reach of children.

⚠ WARNING!

Risk of injury!

 **Not suitable for children under the age of 8! There is a risk of injury!**

 - Children from the age of 8, as well as people with impaired physical, sensory or mental capabilities or with a lack of experience and knowledge, must be supervised when using the

product and/or be instructed regarding the safe use of the product and understand the resulting dangers.

- Children are not allowed to play with the product.
 - Maintenance and/or cleaning of the product is not allowed to be performed by children without supervision.
- Observe national regulations!**
- Observe the applicable national requirements and regulations for the use and disposal of the product.
- Pay attention to ambient conditions!**
- The product may not be charged and used at ambient temperatures above 50°C or below 0°C.

⚠ WARNING!

Risk of injury!

 **Do not use in an explosive environment! There is a risk of injury!**

- The product is not allowed to be used in an explosive (Ex) environment. The product is not approved for an environment, in which flammable liquids, gases or dust are present.

⚠ WARNING!

Risk of injury!

A defective product is not allowed to be used! There is a risk of injury!

- Do not use the product in the case of malfunctions, damage or defects.
- If you discover a defect in the product, have the product checked by a specialist and repaired if necessary before you use it again.
- Significant danger can occur for the user in the case of improper repairs.
- The light source contained in the product may only be replaced by the manufacturer, its customer service or a similarly qualified person.
- If the product makes unusual noises,

switch it off immediately and allow it to cool for at least 15 minutes.

- Leaked or damaged batteries may cause acid burns if they come into contact with skin. Do not touch leaked batteries with bare hands; therefore, ensure that you wear appropriate protective gloves in such a case!

⚠ WARNING!

Risk of injury!

⚡ The product is not allowed to be manipulated! There is a risk of injury from electric shock!

- The casing must not be opened and the product must not be manipulated/modified under any circumstances. Manipulations/modifications can cause danger to life from electric shock. Manipulations/modifications are prohibited for approval reasons (CE).
- The product must not be covered up during use.
- Do not expose the product to rain or damp weather or immerse it in water. There is a danger of electric shock!

SAFETY INSTRUCTIONS REGARDING RECHARGEABLE BATTERIES

⚠ WARNING!

Fire and explosion hazard!

- Keep the product away from heat sources and direct sunlight: the battery may explode if overheated. There is a risk of injury.
- Do not operate the product in its packaging! There is a risk of fire!

⚠ WARNING!

Risk of injury!

👤 Do not touch leaked batteries with bare hands! There is a risk of injury!

NOTE!

- This product has a built-in rechargeable battery that cannot be replaced by the user. In order to avoid hazards, the battery may only be removed by the manufacturer or its service agent or by a similarly qualified individual.
- When disposing of the product, please note that this product contains a rechargeable battery.

SAFETY INSTRUCTIONS FOR THE PRODUCT

⚠ WARNING!

Risk of explosion and injury!

🔥 Risk of explosion and injury when damaged pumps are used!

- Pumps with damaged connecting parts or other defects or damage may no longer be used due to the danger of explosion and injury.
- Defective pumps must be disposed of properly. A repair is not possible.
- Only use accessories supplied and recommended by the manufacturer.
- Avoid excessive stress on the product. The Compressed air hose with threaded connection **2** must not be kinked during use.

⚠ WARNING!

Risk of explosion!

🔥 Risk of explosion when exceeding the maximum value!

- You can inflate all bicycle tyres, car tyres and small volume inflation articles up to the specified maximum allowable pressure of the pump (max. 8.25 bar / 120 PSI) or up to the specified maximum air pressure of the tyre manufacturer, article manufacturer. You can usually find this on the sidewall of the tyre, or in the technical data of the inflation article. If you are not sure, ask a professional.
- The indicated maximum values must not be exceeded at any time!
- The product is not suitable for large tyres such as tractor or truck tyres.

⚠ WARNING!

Risk of burning!

The product becomes warm during operation. Risk of burning!

- The front part of the product in particular, as well as the pump hose and valve adapter, are heated up more the longer the product pumps.
- Allow the product to cool down before touching it again.
- Keep the openings for air intake clear during operation. Do not block the openings with hands or fingers.
- Do not put the product down during operation. Hold the product at least with one hand.
- Ensure that no sand, dust or other small foreign bodies enter the openings for air intake.
- If you notice a leakage or a strange smell of the product or if the product deforms, stop using it immediately and contact the service address.

⚠ CAUTION!

Risk of injury!



📏 Risk of injury with incorrect tyre pressure!

- The digital manometer with air pressure display of the product is not calibrated!
- For your own safety, please check the air pressure using a calibrated pressure gauge (e.g. at a petrol station).

START-UP

1. Remove all packaging materials.
2. Check whether all parts are available and undamaged. If this is not the case, notify the specified service address.

Legend

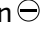
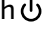
- 1** Rechargeable compressor
- 2** Compressed air hose with threaded connection
- 2a** Valve adapter
- 3** USB charging cable
- 3a** USB plug
- 4** Car charging adapter
- 4a** Plug
- 5** Dunlop/Presta valve adapter
- 6** Metal adapter for balls
- 7** Plastic adapter for inflatable articles
- 8** Storage bag
- 9** On/Off button 
- 10** Display
- 11** Battery indicator
- 12** Charge indicator
- 13** Charging plug
- 14** Socket
- 15** Pressure indicator
- 16** Setting button 
- 17** Setting button 
- 18** On/Off pressure switch 
- 19** Auxiliary light
- 20** Light switch
- 21** Air slots

- X** Schrader valve
- Y** Dunlop valve
- Z** Presta valve

Charging the battery (Fig. B)

NOTE!

- The battery must be charged before the first use.
- The battery must be charged as soon as only 1 bar is left in the battery indicator **11**.
- The auxiliary light **19** (see **Fig. L**) may not be switched on during the charging process.
- During the charging process with the USB charging cable **3**, the product cannot be used for pumping for safety reasons. There is a risk of overheating.

Checking battery charge level (Fig. B)

1. Switch on the product by pressing the on/off button **9**.
- The display **10** switches on. The number of bars on the battery indicator **11**, indicate the charge level of the battery.
- When the battery is fully charged, 4 bars are displayed.

⚠ WARNING!

- Risk of injury from electric shock!**
- Only charge the product in interior spaces.
 - If the product has become wet, you must dry the product completely with a dry cloth before charging. There is a risk of short circuit.

NOTE!

- The battery is fitted with an automatic

switch-off device. This switches off the charging process with a 100 % charge, so that the battery cannot be overcharged.

- It is best to charge the product every 4 weeks to prevent the battery cells from discharging.
- Only use the USB charging cable **3** or the car charger **4** supplied with the product.
- Charge the battery only at an ambient temperature between 0 °C and 50 °C.
- If the battery of your car is old, the battery should not be charged using the car charger **4**. It is possible that your car will not start afterwards.

Charging battery with USB charging cable (Fig. C)

Connect the product to an appropriate device **3** using the USB charging cable. You can charge the battery with a power adapter with USB port, please refer to the technical data.

The product can only be connected to a control device with a SELV output and a maximum working peak output voltage (U_{out}) of 5 V. 

- During the charging process, the charging indicator **12** on the USB plug **3a** lights up red.
 - Once the battery is fully charged, the charge indicator **12** lights up green.
1. Switch off the product.
 2. Plug the charging plug **13** into the socket **14**.
 3. Insert the USB plug **3a** into the charging device.
 4. When the charging process is complete, remove the charging plug **13** from the socket **14** and the USB plug **3a** from the charging device.

Charging the battery with the car charging adapter (Fig. D)

⚠ WARNING!



Please note that while charging with the the car charger **4**, the product should not be used for continuous operation in order not to overload the car battery and the product. When charging using the car charger **4**, the charger **4** must always be fully inserted into the car's cigarette lighter. Otherwise there is a risk of fire due to overheating.

1. Switch off the product.
2. Plug the charging plug **13** into the socket **14**.
3. Insert the plug **4a** of the car charger **4** into the cigarette lighter socket.
4. When the charging process is complete, remove the charging plug **13** from the socket **14** and the plug **4a** from the cigarette lighter.

USE

Screw the compressed air hose with threaded connection **2** into the product, see **Fig. E**.

Using the adapters

For car tyres - Schrader valve **X**:

1. First, remove the dust cap.
2. Screw the valve adapter **2a** on the compressed air hose with threaded connection **2** to the Schrader valve **X**, see **Fig. F**.

For bicycle tyres with Dunlop valve **Y**:

1. Screw the Dunlop/Presta Valve adapter **5** into the valve adapter **2a** of the compressed air hose with threaded connection **2**.

2. Remove the dust cap.
3. Screw the Dunlop/Presta Valve adapter **5** onto the Dunlop valve **Y**, see **Fig. G**.

For bicycle tyres with Presta Valve **Z**:

1. Screw the Dunlop/Presta Valve adapter **5** into the valve adapter **2a** of the compressed air hose with threaded connection **2**.
2. Remove the dust cap.
3. Loosen the nut of the Presta Valve **Z** (3.a-3.c).
4. Screw the Dunlop/Presta Valve adapter **5** onto the Presta Valve **Z**, see **Fig. H**.
(Valves **X**, **Y**, and **Z** not included in the scope of delivery)

For balls:

1. Screw the metal adapter for balls **6** into the valve adapter **2a** of the compressed air hose with threaded connection **2**, see **Fig. I**.
2. Now, insert the metal adapter **6** into the ball.

For small volume inflatable articles:

1. Screw the plastic adapter for inflatable articles **7** into the valve adapter **2a** of the compressed air hose with threaded connection **2**.
2. Insert the plastic adapter for inflatable articles **7** into the inflatable article, see **Fig. J**.

Switching the product on/off

⚠ CAUTION!

Risk of injury!



The device generates a sound pressure level of approx. 90 dB. There is a risk of hearing damage!

age!

- Wear suitable hearing protection

when using the product.

(Fig. K)

To switch on, press the on/off button  **9** below the display **10**.

- The display **10** lights up.
- The last applied pressure indication, PSI, BAR or KG/CM² is displayed.

To switch off, press the on/off button  **9** for approx. 3 seconds.

NOTE!

If the product is not operated for more than 90 seconds, it switches off automatically.

Measuring tyre pressure

NOTE!



Applies only to Schrader valve

:





1. First, remove the dust cap.
2. Screw the valve adapter **2a** on the compressed air hose with threaded connection **2** to the Schrader valve , see Fig. F.
2. Switch on the product, see Fig. K.
3. The **10** display lights up and the last set pressure indicator **15** PSI, BAR or KG/CM² is displayed.
4. The pressure existing in the inflated item is shown in the corresponding pressure display.

Set pressure

(Fig. K)

1. Turn on the product as described above.
2. By briefly pressing the on/off button  **9** you can set the desired pressure to PSI, BAR or KG/CM². The pressure display **15** shows the value 0.00.
3. By pressing the setting buttons **16**  or **17**  you switch to the pressure specification.

- The last set pressure is displayed and flashes.

3. By pressing the setting buttons **16**  or **17**  you can now set the pressure up to the max. pressure of 8.25 bar / 120 PSI / 8.41 KG/CM².
- If you press and hold down the setting buttons **16**  or **17** , the setting will be accelerated.
4. When the desired pressure is set, wait about 2 seconds.
- The display changes back to the pressure indication. The pressure display **15** shows the value 0.00.

NOTE!

The set pressure is automatically converted into the other pressure values. For example, if you set 2.5 BAR and then switch to PSI, the value is automatically converted to 36 PSI.

Pumping process

WARNING!

Risk of overheating

- The air slots **21** on the underside of the product (Fig. M) must not be covered during the pumping process. There is a risk of overheating.

(Fig. L)

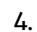

1. When the product is off, turn the product on as described above.
2. Now press the on/off button **18**  on the top of the product. The built-in compressor starts and runs until the set pressure is reached.

NOTE!

During the pumping process the current pressure is displayed.

3. After reaching the set pressure, the compressor stops pumping.
4. Press the on/off pressure switch **18**  on the top of the product to switch off the compressor.

NOTE!

- You can only activate the compressor if the product has been switched on using the on/off button  **9**.
- You can switch off the compressor before it reaches the set pressure. To do this, press the on/off pressure switch **18** .

Note, that if you switch off the compressor before reaching the set pressure, the inflated item, e.g. a bicycle tyre, may not meet the required specifications (tyre pressure).

5. After the pumping process, unscrew the compressed air hose with threaded connection **2** or any screwed-in adapters **5**, **6** or **7** from the valve.
6. If present, screw the dust cap onto the valve.

NOTE!

Applies only to Presta valve **2**:
Close the valve and screw on the dust cap.

NOTE!

Air can escape from the valve when the compressed air hose with threaded connection **2**, or the previously described adapters **5**, **6** or **7** from the valve is disconnected. Be sure to remove the threaded air hose **2** or adapters **5** **6** **7** quickly.

Auxiliary light on/off

NOTE!



The LED lamp of the auxiliary light is suitable for extreme temperatures down to -21°C.

(Fig. L)

To switch on the auxiliary light **19** press the light switch **20**.

To switch off, press the light switch **20** again.

The auxiliary light **19** can be used independently of the product.

TROUBLESHOOTING

No reaction when the product is switched on by pressing the on/off button  **9**

- The battery is not charged. Charge the battery.

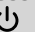
No reaction when the compressor is switched on by pressing the on/off pressure switch **18 **

- The battery is not charged. Charge the battery.
- The product is not switched on. Switch on the product by pressing the on/off button  **9**.

CLEANING AND CARE INSTRUCTIONS

CAUTION!

Risk of injury!



Before cleaning, you must disconnect the charging plug. There is a risk of electric shock!

- only clean with a dry cloth
- do not use any strong detergents and/or chemicals
- do not immerse in water
- store in a cool, dry place and protected

- from UV light
- For storage, pack the product and its accessories in the storage bag .

DISPOSAL

Disposal of the packaging



The packaging and operating instructions are made of 100 % environmentally friendly materials, which you may dispose of at local recycling centres.



Not Recyclable - Soft plastic is not recyclable at a MRF, and is not widely collected at kerbside.

Disposal of the product



The product may not be disposed of with normal household waste. Please find out about disposal options for the product from your local authority or town administration.

Disposal of the battery / rechargeable batterie



- The product and the rechargeable batterie may only be disposed of by specialists.
- Defective or used rechargeable batteries have to be recycled in accordance with Directive 2006/66/EC and its amendments.
- Batteries and disposable batteries are not permitted to be disposed of with household waste. They contain harmful heavy metals. Marking: Pb (= lead), Hg (= mercury), Cd (= cadmium). You are legally obligated to return used batteries and rechargeable batteries. After use, you can either return batteries to our point of sale or in the direct vicinity (e.g. with a retailer or in municipal collection centres) free of charge. Batteries and rechargeable batteries

are marked with a crossed-out waste bin.

- Rechargeable batteries / accumulators may only be disposed of in a discharged state or must be secured against short circuits (e.g. with insulating tape) for disposal.
